

Bonnethill Gardens

Bonnethill Gardens is a Retirement Plus development

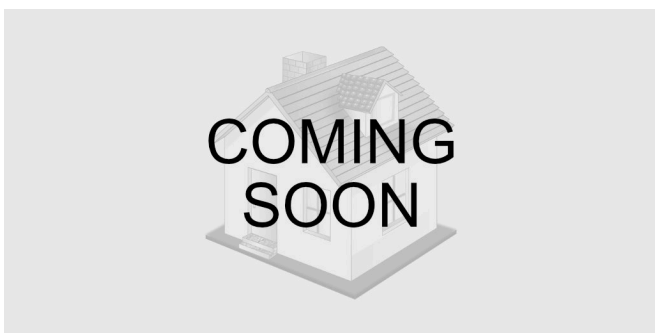

Bonnethill Gardens

About our Housing

A warm welcome awaits you at Bonnethill Gardens, Dundee which offers safe and secure homes designed especially for those aged 60 and over. Our Local Manager provides a friendly face and ensures the buildings and facilities are kept in good order. Bonnethill Gardens is situated in the Hilltown area of Dundee, close to bus stops and shops. Dundee has a variety of shops, public parks and a railway station.

If you would like to make an application to live at this Bield development, you can download an application from our website or contact the development directly.

If you need help to complete the form, please do not hesitate to contact us by calling 03000 132 162 or emailing applicants@bield.co.uk

About this development

Number of Properties

44

Area Housing Manager

Sharon Tomany

Property Officer

Tom Sewell

Development address:

Bield, Bonnethill Gardens
Bonnethill Gardens
1 Caldrum Terrace
Dundee
DD3 7HB
Tel: 01382 202 087

**The cost of living at the development**

Many of our tenants get support with their housing costs.

If you are interested in living at Bield and would like to explore whether you are eligible for support, please contact Sharon Tomany on 0131 273 4000

Monthly rental charges:

The monthly rental charges range from:
£610.39 - £888.00

The cost to live at one of our developments is currently presented as a single cost. We have a scale of costs because it depends on the size of property you rent. From April 2023 you will be able to see the component costs of our service, as detailed below; rental charge, staffing costs, communal area energy charges, domestic energy charges (where appropriate) and any optional meal charges.

Meals Charges

The monthly meal charges range from;
£81.00 - £404.60

Guest Rooms:

There is an ensuite guest room which friends and families can book.

£10.00 - £14.00 per night, per person

Bonnethill Gardens

What services are available at the development

This development is a Retirement Plus property. Find out what services are available below.

| |  Amenity Housing |  General Needs Housing |  Retirement Housing |  Retirement with Meals Housing |  Retirement Plus Housing |  Owner Services |
|--|---|---|--|--|---|--|
|  Security | 24 Hour Emergency Telephone Response | ✗ | ✗ | ✓ | ✓ | ✓ |
| | Security Access | ✗ | ✗ | ✓ | ✓ | ✓ |
|  Facilities and Services | Quality Homes, Design and Facilities | ✓ | ✓ | ✓ | ✓ | ✓ |
| | Privacy | ✓ | ✓ | ✓ | ✓ | ✓ |
| | Communal Area & Cleaning | ✗ | ✓ | ✓ | ✓ | ✓ |
| | Maintained Communal Gardens | ✓ | ✓ | ✓ | ✓ | ✓ |
| | Emergency Repairs | ✓ | ✓ | ✓ | ✓ | ✓ |
| | Building Insurance | ✓ | ✓ | ✓ | ✓ | ✓ |
| | Planned Maintenance Programme | ✓ | ✓ | ✓ | ✓ | ✗ |
| | Car Parking | ✓ | ✓ | ✓ | ✓ | ✓ |
| | Potential to own part or all of your home | ✗ | ✗ | ✗ | ✗ | ✓ |
|  Support Services | Local Staff Presence | ✗ | ✗ | ✓ | ✓ | ✓ |
| | Meals Service (Additional Charge) | ✗ | ✗ | ✗ | ✓ | ✗ |
| | Care Service (Additional Charge) | ✗ | ✗ | ✗ | ✓ | ✗ |
|  Additional Services | Pets Possible | ✓ | ✓ | ✓ | ✓ | ✓ |
| | Support with Social Activities | ✗ | ✗ | ✓ | ✓ | ✓ |
| | Guest Room for Family and Friends | ✗ | ✗ | ✓ | ✓ | ✓ |